

LECOSYS[®]

TAU









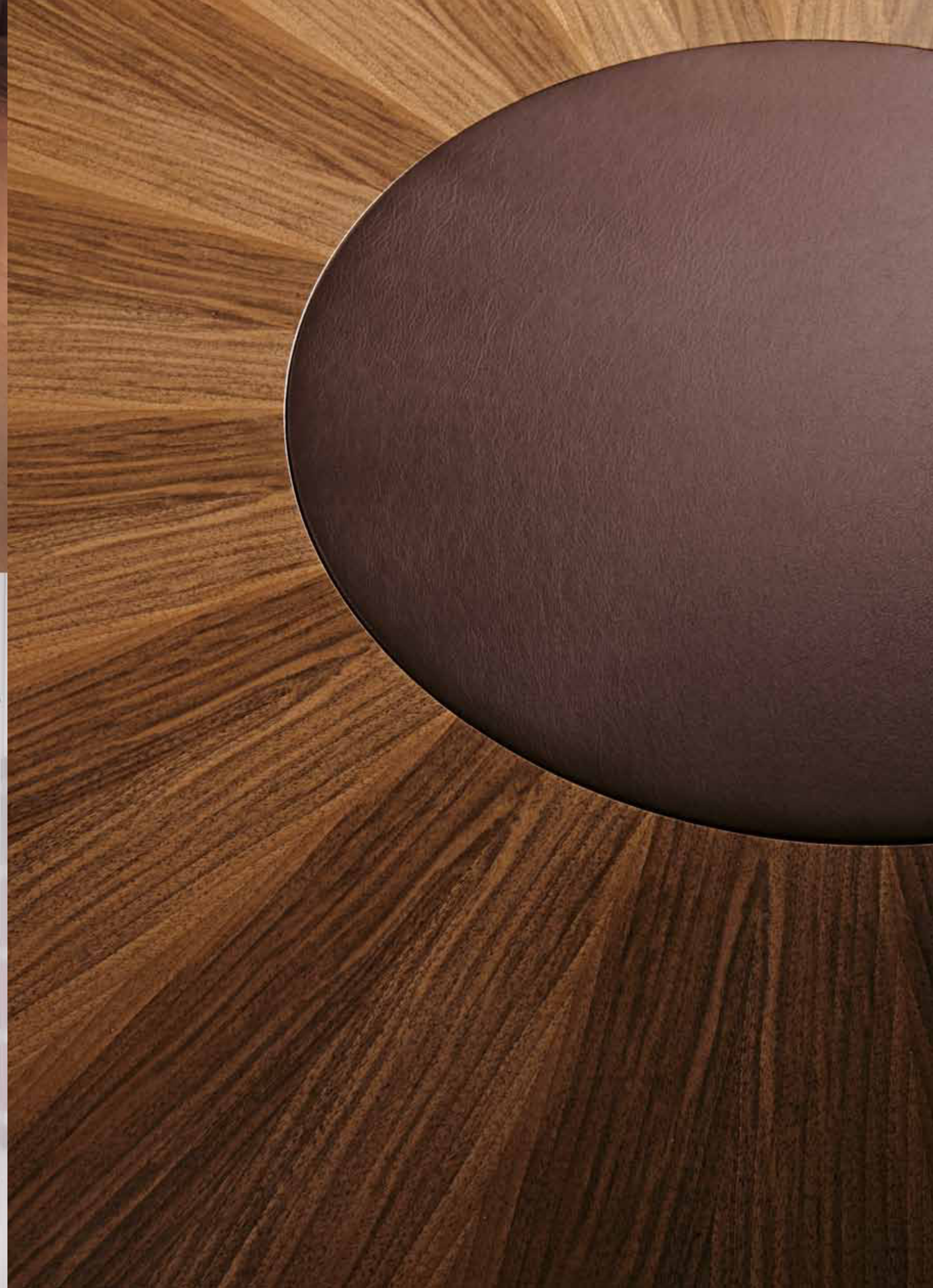

Bright white



feeling LIGHT

Only with the use of brushed gloss paint on all white surfaces can you obtain that particular sensation of richness and brightness, as the effect of the reflections of LIGHT creates, dancing over the surfaces.



Dark oak

feeling EQUILIBRIUM

Often we seek a comforting sensation of EQUILIBRIUM in the work environment, where we spend much of our time each day. One way to do so is to surround ourselves with warm and in particular natural forms and materials, such as the dark Italian walnut used to veneer this desk, sure of the fact that no imitation can touch the fantastic and always unique result of the natural growth of a plant.

Italian walnut

Dark oak



feeling IMPACT

The dark tone of the colour used in this office exalts the general IMPACT of the environment through an effect of harmonious contrasts between the horizontal lines of the solid dark wood panelling and the soft, almost sensual, curves of the desk.

Dark oak



feeling IMPACT

The uniqueness of the environment, also in such a dark colour, is in any case guaranteed by the use of natural oak veneering. As you get closer to the furniture, you'll discover the uniqueness of the natural design, never the same and delightfully different both in itself and from others. Always sure to make a significant IMPACT.

Dark oak

Dark oak



feeling PRESTIGE

We tried staining natural oak and we're sure to have obtained an excellent effect, but what can one say of nature's work on ebony veneer: Ultimate PRESTIGE, matchless, sober, formal, elegant, but more than anything so varied and uncontrollable to guarantee a truly unique and exclusive result, when selected and worked with care and competence.



desk with/without side extension



low storage unit

tall storage unit



draught screen





round table



meeting table



book case



TAU (H-L-P)

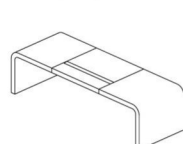

AM260 76 - 260 - 100
AM285 76 - 285 - 100

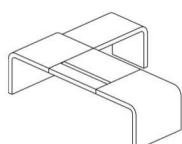

AM260A 76 - 260 - 220
AM285A 76 - 285 - 220

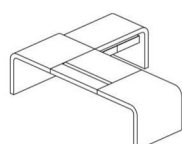

AM260C 76 - 260 - 220
AM285C 76 - 285 - 220



AM133E 76 - 133 - 80

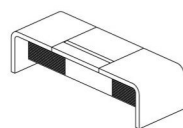

AM260F 76 - 260 - 100
AM285F 76 - 285 - 100

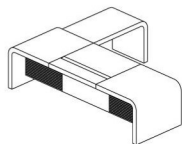

AM260AF 76 - 260 - 220
AM285AF 76 - 285 - 220

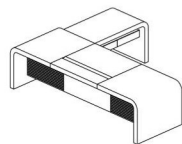

AM260CF 76 - 260 - 220
AM285CF 76 - 285 - 220



AM042R 59 - 42 - 60



AM170T 76 - Ø 170

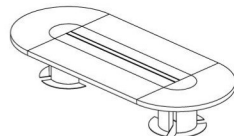

AM410T 76 - 410 - 170



AM060TS 40 - 60 - 60
AM120TS 40 - 120 - 60

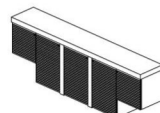

AM05BR 91 - 267 - 46
AM06BR 91 - 317 - 46

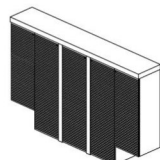

AM05AR 169 - 267 - 46
AM06AR 169 - 317 - 46

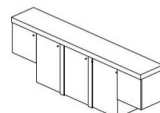

AM05B 91 - 267 - 46
AM06B 91 - 317 - 46

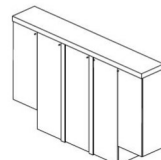

AM05A 169 - 267 - 46
AM06A 169 - 317 - 46



AM04G 230 - 220 - 41

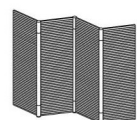

AM4PAR 140 - 50 (218) - 6
AM6PAR 140 - 50 (330) - 6



AM066R 230 - 66 - 9
AM100R 230 - 100 - 9



AM066 230 - 66 - 9
AM100 230 - 100 - 9

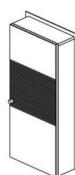

AM231R SX 230 - 100 - 15-30
AM232R DX 230 - 100 - 15-30

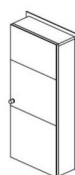

AM231 SX 230 - 100 - 15-30
AM232 DX 230 - 100 - 15-30

PIANO/GAMBA SCRIVANIE (ESCLUSO FRONTALE), PIANI TAVOLI RIUNIONE E TAVOLINI SALOTTO TOP/LEG FOR DESK (EXCEPT FRONT), TOP MEETING TABLES AND COFFE TABLE

IMPIALLACCIATO / VENEERED



LACCATO LUCIDO / BRUSHED LACQUERED



PARTI INTERNE INTERNAL PARTS

LACCATO / LACQUERED



FRONTALE SCRIVANIA FRONT DESK

LISTELLI / STRIPS

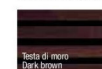

PELLE / LEATHER



CONTENITORI STORAGE UNITS

STRUTTURA STRUCTURE

IMPIALLACCIATO / VENEERED



LACCATO LUCIDO / BRUSHED LACQUERED



PARTI INTERNE INTERNAL PARTS

LACCATO / LACQUERED



ANTE DOORS

IMPIALLACCIATO / VENEERED



LACCATO LUCIDO / BRUSHED LACQUERED



LACCATO / LACQUERED



LISTELLI / STRIPS

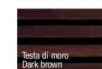

CASSETTIERA SU RUOTE DRAWER UNIT ON CASTORS

IMPIALLACCIATO / VENEERED



LACCATO LUCIDO / BRUSHED LACQUERED



LACCATO / LACQUERED



MODULI BOISERIE WOODEN MODULAR PANELS

IMPIALLACCIATO / VENEERED



LACCATO LUCIDO / BRUSHED LACQUERED

COLONNA E MODULI PORTA COLUMN AND DOOR MODULES

IMPIALLACCIATO / VENEERED



LECOSYS®



10/2014